

## REMOVAL

1. **REMOVE BATTERY**
2. **DRAIN ENGINE COOLANT** (See page [CO-3](#))
3. **DRAIN ENGINE OIL** (See page [LU-4](#))
4. **REMOVE POWER STEERING LINK ASSEMBLY (for 2WD)**  
Refer to the procedures up to "REMOVE POWER STEERING LINK ASSEMBLY" (See page [PS-18](#)).
5. **REMOVE POWER STEERING LINK ASSEMBLY (for 4WD)**  
Refer to the procedures up to "REMOVE POWER STEERING LINK ASSEMBLY" (See page [PS-37](#)).
6. **REMOVE FRONT DIFFERENTIAL CARRIER ASSEMBLY (for 4WD)**  
Refer to the procedures up to "REMOVE FRONT DIFFERENTIAL CARRIER ASSEMBLY" (See page [DF-20](#)).
7. **REMOVE FAN**  
Refer to the procedures up to "REMOVE FAN" (See page [CO-17](#)).
8. **REMOVE GENERATOR ASSEMBLY**  
Refer to the procedures up to "REMOVE GENERATOR ASSEMBLY" (See page [CH-9](#))
9. **SEPARATE COOLER COMPRESSOR ASSEMBLY** (See page [ES-420](#))
10. **REMOVE V-RIBBED BELT TENSIONER ASSEMBLY** (See page [EM-22](#))
11. **REMOVE OIL LEVEL GAUGE GUIDE** (See page [EM-22](#))
12. **SEPARATE VANE PUMP ASSEMBLY** (See page [EM-22](#))
13. **REMOVE NO. 2 IDLER PULLEY SUB-ASSEMBLY** (See page [EM-23](#))
14. **REMOVE NO. 1 IDLER PULLEY SUB-ASSEMBLY** (See page [EM-23](#))
15. **REMOVE CRANKSHAFT PULLEY** (See page [EM-23](#))
16. **REMOVE NO. 2 OIL PAN SUB-ASSEMBLY** (See page [EM-23](#))
17. **REMOVE OIL STRAINER SUB-ASSEMBLY** (See page [EM-24](#))
18. **REMOVE OIL PAN SUB-ASSEMBLY** (See page [EM-24](#))
19. **REMOVE AIR CLEANER ASSEMBLY** (See page [ES-429](#))

20. REMOVE THROTTLE BODY BRACKET (See page [FU-11](#))
21. REMOVE OIL BAFFLE PLATE (See page [FU-11](#))
22. REMOVE NO. 1 SURGE TANK STAY (See page [FU-11](#))
23. REMOVE NO. 2 SURGE TANK STAY (See page [FU-12](#))
24. REMOVE INTAKE AIR SURGE TANK (See page [FU-12](#))
25. REMOVE IGNITION COIL ASSEMBLY (See page [IG-8](#))
26. REMOVE CAMSHAFT TIMING OIL CONTROL VALVE ASSEMBLY (See page [ES-414](#))
27. REMOVE VVT SENSOR (See page [ES-417](#))
28. REMOVE WATER INLET (See page [CO-8](#))
29. REMOVE CYLINDER HEAD COVER SUB-ASSEMBLY (See page [EM-40](#))
30. REMOVE CYLINDER HEAD COVER SUB-ASSEMBLY LH (See page [EM-40](#))
31. REMOVE OIL FILTER BRACKET SUB-ASSEMBLY
  - (a) Remove the 3 bolts, 2 nuts, oil filter bracket and gasket.

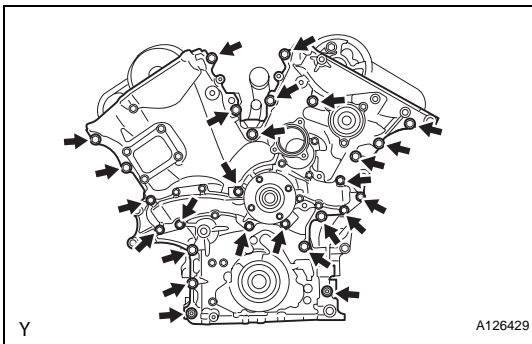
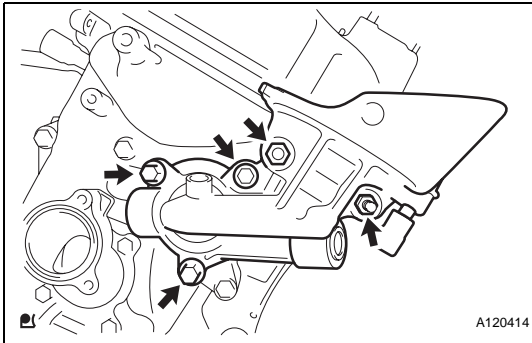

32. REMOVE TIMING CHAIN OR BELT COVER SUB-ASSEMBLY
  - (a) Remove the 24 bolts and 2 nuts.